

**TABLICA SA KARAKTERISTIČNIM MERAMA
ZA VENTILATORE TIP SRV**

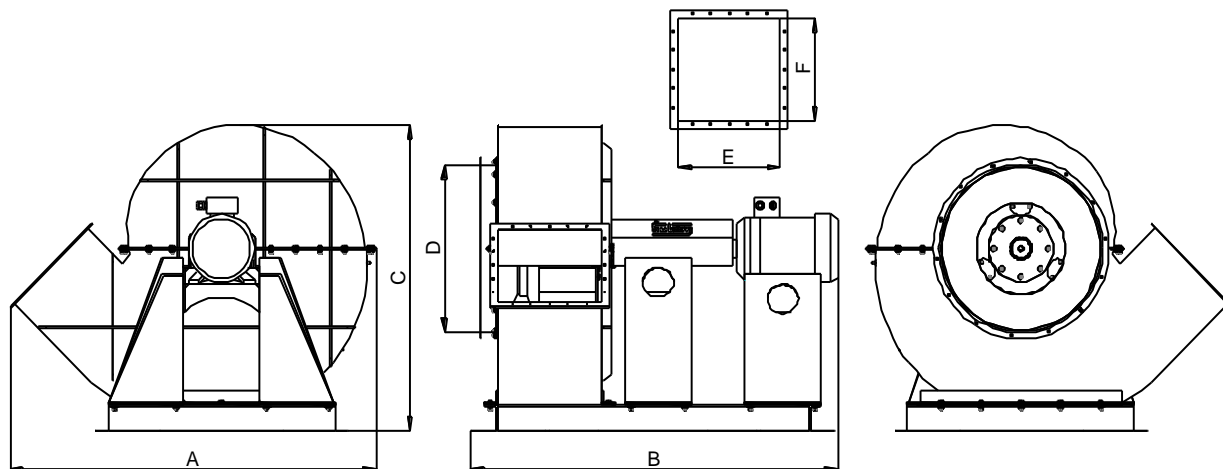

Ventilator	DIMENZIJE VENTILATORA					KARAKTERISTIKE VENTILATORA pri n=1400 o/min				Težina (kg)
	A	B	C	D	ExF	Qmin (m ³ /s)	Pmax (Pa)	Qmax (m ³ /s)	Pmin (Pa)	
SRV 27	460	415	420	210	120x142	0,045	310	0,125	150	27
SRV 32	585	595	605	310	140x156	0,065	375	0,19	180	32
SRV 40	985	830	835	390	245x252	0,125	600	0,37	300	46
SRV 50	1210	1315	1015	500	309x315	0,25	900	0,75	480	110
SRV 63	1425	1430	1155	620	385x400	0,51	1500	1,4	750	167
SRV 71	1540	1570	1305	650	450x520	0,75	1900	2,1	900	215
SRV 80	1670	1750	1515	750	500x650	1,05	2400	3	1200	275
SRV 90	1820	1890	1630	800	620x700	1,5	3000	4,5	1500	340